

DIY horizontal elbow for cable trays

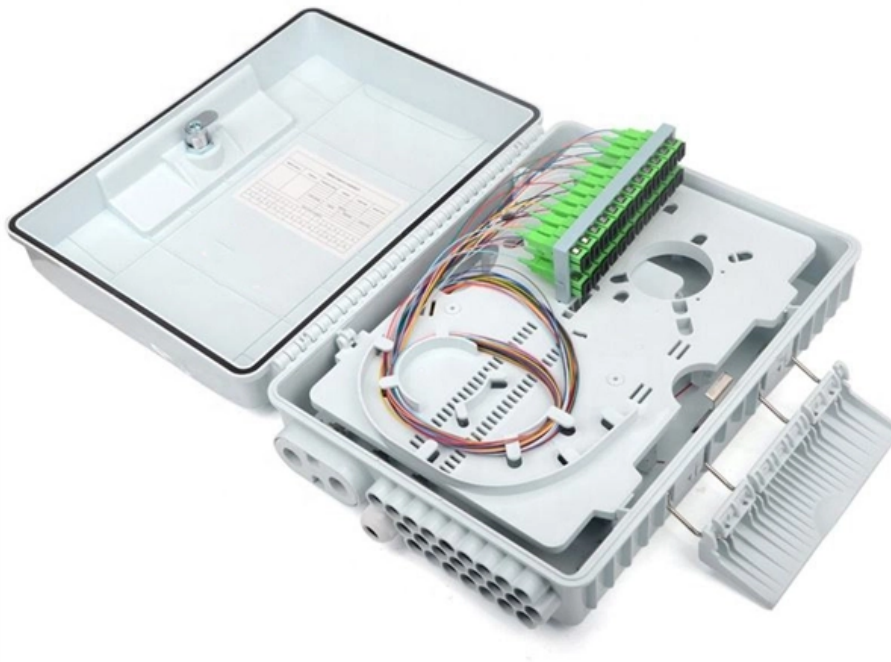



DIY horizontal elbow for cable trays

Vertical Cable Support Elbow , Ladder Trays , Cable Tray and Reels

The aluminum I-beam design of ITray is perfect for industrial installations with large diameter cables in long span situations, minimizing total tray width and creating a smooth transition between straight

[Read More](#)

Cable Tray / Wire Mesh Basket Tray TMX-XX-HE90 INSTALLATION L

reate a 90o sharp horizontal elbow us. g TM4-12 mesh: Step 1: Locate area within mesh tray to trim. Trim away cross hatc. ed areas of mesh using MM-ACC-BTC cutting tool or equivalent. Dimensions

[Read More](#)



Cable Ladder Trays

Cable ladder trays have side rails with rungs to route and support cable. The rungs allow cable to enter and exit anywhere along the span, and they facilitate future changes. These trays also provide free

[Read More](#)

90° Horizontal Elbow , Cable Tray Systems , PUPCO

The 90° Horizontal Elbow provides essential support and enables seamless cable management throughout your cable routing system. All fittings have 3" tangents

[Read More](#)

60° Horizontal Elbow , Cable Tray Systems , PUPCO

Discover our 60° Horizontal Elbow for cable tray systems. Contact us today for



availabilities and receive a quote. Fast shipping guaranteed

[Read More](#)

Professional Cable Tray Elbow Making , Metal Fabrication Tutorial

This video shows metal fabrication techniques, DIY cable tray projects, and tips for perfect bends and joints.

[Read More](#)

30° Horizontal Elbow , Cable Tray Systems , PUPCO

Discover our 30° Horizontal Elbow for cable tray systems. Seamlessly transition between sections and fittings, reducing tray width. Contact us today!

[Read More](#)



Fiberglass Cable Tray Horizontal Elbows 45°

Compact fiberglass 45 degree horizontal bend fitting for Cope cable tray systems--pre-drilled for easy installation.

[Read More](#)

30° Horizontal Elbow , Cable Tray Systems , PUPCO

The 30° Horizontal Elbow is an ideal choice for installations where large diameter cables are involved in long span situations. It effectively reduces the overall tray

[Read More](#)

Solved: Cable Tray Elbow

Solved: Good day, In need to create an elbow that starts at a right angle and that has the ability adopt the angle of the routing of the cable tray.

[Read More](#)



Cable Tray Elbow (Horizontal) - G-STEEL TRADING

Usage: is used to complete the whole project as it is one of the cable tray accessories, that make the cable go through all available space easily as it can

[Read More](#)

5"

Enhance cable routing with Primus Cable's Horizontal 90° Elbow. Engineered for smooth 90° sweeps, it meets minimum bend radius and allows quick, secure install.

[Read More](#)

Steel Cable Tray Horizontal Elbow



As a market leader; we offer all types of cable tray accessories including Cable Tray Horizontal Elbow that are used for successfully handling of cables. These are

[Read More](#)

HOW TO FABRICATE (INSIDE ELBOW)AND(OUTSIDE ELBOW)

How to bend 90 degree of cable tray accurate to joint and support with 22.5 degree offset o HOW TO BEND 90 DEGREE OF A CABLE TRAY AC

[Read More](#)

How to Produce Ladder Cable Tray: A Technical Manual

This manual is designed to guide workers through the detailed production process of ladder cable trays, including the manufacture of horizontal

[Read More](#)



CABLE TRAY SYSTEMS GUIDE

Square Corners: 90 Degree Horizontal Elbows, Horizontal Tees and Horizontal Crosses are available with square corners (0" Radius). The 6" through 18" square-corner fittings are designed to align with

[Read More](#)

How to make Cable tray VERTICAL OUTSIDE ELBOW 90°deg. (45

Vertical outside elbow 90°degree(45°-45°) 50mm depth cable tray. Practical tutorial 5

[Read More](#)

Cable Tray Elbow (Horizontal) - G-STEEL TRADING

A cable tray elbow. Usage: is used to complete the whole project as it is one of the cable tray accessories, that make the cable go through all available space easily

[Read More](#)



cable tray system

A cable tray system is an assembly of metallic cable tray sections and accessories, that forms a rigid structural system to support cables.

[Read More](#)

electrical #cable tray# making 90,° elbow #

Creating a 90-degree elbow in an electrical cable tray, often called a "fabricated" or "mitered" bend, involves cutting, bending, and fastening a straight section of tray.

[Read More](#)

Cable Tray / Wire Mesh Basket Tray TMX-XX-HE90 INSTALLATION L



) Unless otherwise noted, drawing units are in inch. reate a 90o sharp horizontal elbow us Locate area within mesh tray to trim. ed areas of mesh using MM-ACC-BTC cutting tool or equivalent.

[Read More](#)

Cable tray

Horizontal elbows change direction of a tray in the same plane as the bottom of the tray and are made in 30, 45 and 90 degree forms; inside and outside elbows are

[Read More](#)

I-BEAM Ladder Horizontal Elbows 90°

CopeI-BEAMhorizontal bend for cabletraysystems. Compatible with NEMAClasses 12B, 12C, 20A, 20B, 20C, and higher.

[Read More](#)



Cable Tray Elbow Manufacturer and Supplier in China

Then, cable tray elbows were manufactured to give improvement usage. Furthermore, these are accessible with interior vertical, exterior vertical and

[Read More](#)

electrical #cable tray# making 90,° elbow

Creating a 90-degree elbow in an electrical cable tray, often called a "fabricated" or "mitered" bend, involves cutting, bending, and fastening a straight section of tray. The most common

[Read More](#)

Cable Tray Elbow Cutting/Fabrication

Enjoy the videos and music you love, upload original content, and share it all with



friends, family, and the world on .

[Read More](#)

How To Make Cable Basket 90°horizontal Elbow& T

Compared with traditional cable trays that need to make extra elbow or cross, cable basket is much easier. We only need to offer you some accessories and cut some

[Read More](#)

Contact Us

For datasheets, pricing, or custom data center infrastructure solutions, please visit:
<https://www.zeldaterblanchephotography.co.za>