

# **Samoa Trough Cable Tray Specifications**

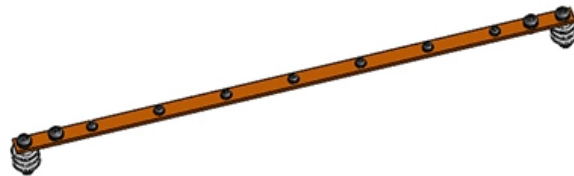



## Samoa Trough Cable Tray Specifications

---

### Section 17.pdf

2.1 Cable tray systems shall be of the design of one manufacturer and shall be designed so that there are no burrs, projections, or sharp edges to damage cable insulation.

[Read More](#)

### CABLE TRAY INSTITUTE

Fabricated in numerous styles (wiremesh, ladder, ventilated trough, channel, and solid-bottom) and sizes, cable tray provides the greatest versatility among cable

[Read More](#)



## **Cable Tray Technical Guide A practical guide to product selection and**

Cable Tray Technical Guide A practical guide to product selection and installation This guide for engineers and installers has been developed by ABB as a practical reference regarding cable tray

[Read More](#)

## **Product Specifications: CABLE TRAY**

FDG CABLE TRAY FDG Cable Tray is designed to continuously support cable systems including; Power, Data, and Audio Visual. A quick and easy system to install without the need for specialised

[Read More](#)

## **304 Stainless Steel Cable Tray 200x100 Customized**

Our 304 Stainless Steel Trough Cable Tray is a high-quality, durable solution designed for the safe and organized management of cables in a wide range of



## **Cable Tray Width, Dimensions and Specifications as per**

Learn about cable tray width dimensions and specifications as per NEC standards. Understand types, sizes, materials, and installation guidelines for safe and

[Read More](#)

## **Product Catalogue Cable Management Solutions**

With over 20 years of experience T& B Cable Tray provides a complete solution in cable managementsystemsincludingdesign,manufacturingandtechnicalsupportbyoffering a complete solution for

[Read More](#)

## **SAMOA CABLE TRAY SPECIFICATION Manufacturer, Function,**



SAMOA CABLE TRAY SPECIFICATION Manufacturer, SAMOA CABLE TRAY SPECIFICATION Datasheet, SAMOA CABLE TRAY SPECIFICATION specifications, SAMOA CABLE TRAY

[Read More](#)

## 12-SDMS-06

SPECIFICATIONS FOR METALLIC CABLE TRAY SYSTEMS This document contains proprietary information developed by and for exclusive use of Saudi Electricity Company (SEC) Distribution

[Read More](#)

## Cable Trough

Tracey Concrete offer a diverse range of Cable Trough Systems designed to protect and hold any necessary utility services. Manufactured from reinforced precast

[Read More](#)



## **Full cable tray systems specification document**

The drawings which constitute a part of these specifications indicate the general route of the cable tray systems. Data presented on these drawings is as accurate as preliminary surveys and planning can

[Read More](#)

## **Cable Tray Specification Guide , Types, Materials, Sizes**

Cable Tray Specification In the realm of infrastructure development, the efficient management of electrical conduits plays a pivotal role. This section delves into the intricacies of selecting and

[Read More](#)

## **TROUGH TRAY**



V-Trough cable tray keeps cabling cool, protected and easy to manage. Its high-strength steel construction matches many European OEM specifications and is available in smaller sizes for control

[Read More](#)

## **CABLE TRAY SYSTEMS GUIDE**

**CONCENTRATED STATIC LOADS:** Some applications may require the cable tray to support the weight of a single, dead object in addition to the cable loads. Specifications typically require this to be

[Read More](#)

## **City Product Center\_1-Tianjin Jzoma Cable Tray Co.,Ltd**

A rigid structure system that closely supports cables, composed of straight sections, bends, tees, and four-way components of trough type.

[Read More](#)



## **CableTray Book English**

Solid trough Fabricated from one sheet to form a continuous one-piece tray design  
Available in aluminum, pregalvanized steel, hot-dipped galvanized steel and stainless steel 316 Fittings are also

[Read More](#)

## **12-SDMS-06**

Cable tray supports shall have a maximum of 6 m spacing on horizontal run and 2.4 m spacing on the vertical runs. However, when the tray system is supported from building structure with rods, brackets

[Read More](#)

## **Cable Trays Specifications**



Find Cable Trays on GlobalSpec by specifications. Cable trays are rigid-type trays used as raceways for cables and wires.

[Read More](#)

## Trough Tray Specification

A. Complete assembly of steel or aluminum (select one) cable tray system and necessary accessories shall be provided as shown on plans. Install entire cable tray system in accordance with all local

[Read More](#)

## GUIDE CABLE TRAYS TECHNICAL

NEMA VE 1-2017 Specifies requirements for metal cable trays and associated fittings designed for use in accordance with the rules of Canadian Electrical Code, Part I and the National Electrical Code®

[Read More](#)



## **National Building Code of Samoa 2017 , PDF , Building Code**

This document is the National Building Code of Samoa published on February 1, 2017. It acknowledges the contributions of various government agencies, private sector representatives, and

[Read More](#)

## **Trough Cable Trays**

Trough Cable Trays Specification: Custom order accepted. Trough Cable Trays offer moderate ventilation with added cable support frequency. It has the bottom

[Read More](#)

## **Technical Specification for Cable tray installation and cable laying work**



1. Scope :- This specification covers the following major activities; - Fabrication and installation of Mild Steel (MS) support structure for Galvanized Iron (GI) Cable tray. - Installation of perforated GI Cable

[Read More](#)

## **QCS 2010: Cable Tray Specifications , PDF , Cable , Screw**

Tray components must be accurately formed to tolerances with rounded edges. Cable trays installed in hazardous environments shall be constructed from heavy

[Read More](#)

## **Detailed Bridge Inspection Report**

The Contactor shall at all times comply with all Samoa Water Authority Regulations currently in force. All materials and workmanship shall generally comply with the most recent edition of the Samoa Water

[Read More](#)



## Cable Tray SHIB NAL

Cable trays are not raceways, but they are treated as a structural component of a facility's electrical system. Cable trays are a part of a planned cable management system to support, route, protect and

[Read More](#)

## Contact Us

---

For datasheets, pricing, or custom data center infrastructure solutions, please visit:  
<https://www.zeldaterblanchephotography.co.za>