

Span of Molded Cable Tray

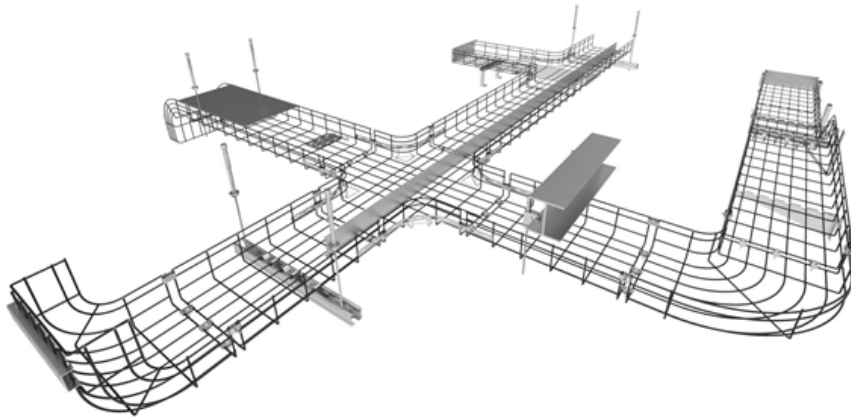



Span of Molded Cable Tray

Factory direct sales Industrial Molded Energy-saving Steel Electrical

The cable trays include: trough type, tray type, large-span type and various models, all of which can be processed and customized. Surface treatments include galvanizing, galvanizing with plastic coating,

[Read More](#)

Span Table For Cable Tray , PDF

Snow and ice load calculations are especially important when the tray is covered. As a rule of thumb the following loads may be used for outdoor applications: a) 12-13

[Read More](#)



CableTray Book English

For example, the first selection issue is the environment to which the cable tray will be subjected. This selection will lead to the best material for your application.

[Read More](#)

Cable Tray Technical Guide A practical guide to product selection and

Cable tray length is selected based on the load to be supported, the distance between the supports (also referred to as the span), and handling and installation constraints.

[Read More](#)

CABLE TRAY SYSTEMS GUIDE

SPAN/LOAD CLASS DESIGNATIONS Commonly called the Load Class, this defines the load-carrying capability of the tray for a specific support span distance. The design and cost of the cable tray is



[Read More](#)

GUIDE CABLE TRAYS TECHNICAL

NEMA VE 1-2017 Specifies requirements for metal cable trays and associated fittings designed for use in accordance with the rules of Canadian Electrical Code, Part I and the National Electrical Code®

[Read More](#)

Nonmetallic

Nonmetallic cable tray systems Nonmetallic cable tray systems have been tested and proven in the harsh environment of the offshore oil and gas industry - subject to the corrosive conditions inherent

[Read More](#)



Cable Tray Dimensions Guide: Standard Sizes, Tray

Explore standard sizes by tray type, understand width and depth limits, and see how to calculate and choose compliant cable tray sizes for real projects.

[Read More](#)

Wire Mesh Cable Trays Technical Information Detailed,

Wire Mesh Cable Tray Installation Notice: Bends, Risers, T Junctions, Crosses and Reducers can be made from wire mesh cable tray straight sections flexibly in

[Read More](#)

Large Span Cable Trays Lay Heavy Cables in Industries

Large span cable trays can be divided into ladder style, channel style, perforated style with galvanized, powder coated surface to resist corrosion. They are widely

[Read More](#)



Guide to cable support systems

In our example (with the blue background), a span of 2.25 m for the cable tray produces a maximum load capacity of 0.75 kN for each running metre of cable tray.

[Read More](#)

Non-Metallic Cable Tray Load Guidelines , PDF , Snow

This document provides information on selecting cable tray classes and load capacities. It includes tables that define the standard loading classes and

[Read More](#)

Long-Span Ladder Cable Tray System

Compared with the common cable tray, the characteristics of the long-span cable tray is



that it has a larger single length and installation length. The length of the

[Read More](#)

CABLE TRAY SYSTEMS GUIDE

Commonly called the Load Class, this defines the load-carrying capability of the tray for a specific support span distance. The design and cost of the cable tray is greatly affected by this designation.

[Read More](#)

Enduro_Specification_Ladder Cable Tray_04-30-21

Connector plates shall be fiberglass and designed with sufficient strength so they may be installed between 0.2 and 0.3 of the length of the span from the support without derating the load carrying

[Read More](#)



Cable Tray

Systems lengths are produced as standard in a 3 metre format, manufactured from sheet steel into a channel section, to provide cable management in all

[Read More](#)

B-Line series Cable Tray Design Considerations

Is your cable tray system optimized for safety, dependability, space and cost savings? Cable tray (or cable ladder) systems are a popular alternative to electrical conduit systems, as they have an

[Read More](#)

Technical information

Technical information CSA and NEMA loading classes The standard classes of cable trays, as related to their maximum design loads and to the associated design support



spacing based on a simple beam

[Read More](#)

Cable Tray Raceway Fill and Load Calculations

Resources For Electrical & Electronic Engineers Cable Tray Raceway Fill and Load Calculations Cable tray / raceway is integral part of any cable management

[Read More](#)

B-Line series Cable Tray Design Considerations

For ladder or ventilated trough trays, the total sum of the cross-sectional areas of all the cables to be installed in the cable tray must be equal to or less than the allowable cable area for the tray width, as

[Read More](#)



Cable Tray Technical Guide A practical guide to product selection and

Cable Tray Technical Guide A practical guide to product selection and installation This guide for engineers and installers has been developed by ABB as a practical reference regarding cable tray

[Read More](#)

An In-depth Analysis for Optimal Cable Tray Support Span

The constructability for the longer span obtained from finite element analysis has been validated in view of manual handling of the cable tray.

[Read More](#)

Span Table For Cable Tray , PDF

Maximum support span of 3 meters providing for normal applications, CLASS D- _ used where long support span of 6 meters and long runs will provide heavy duty



[Read More](#)

26 05 36 Cable Trays for Electrical Systems

span and tested per NEMAVE 1 5.2. In addition to the uniformly distributed load the cable tray shall support 200 lbs. concentrated load at mid-point of span. Load and safety factors specified are

[Read More](#)

How Far Can Cable Tray Support Span?

Spanning Capabilities Maximum Span Length One of the most common questions regarding cable trays is their span length. How far can they stretch? The answer depends on several factors, including the

[Read More](#)



Standard Wire Mesh Cable Trays: Short Span Supports.

Standard Wire Mesh Cable Tray We provide standard Wire Mesh Cable Trays used for low voltage, telecommunication, and fiber optic cables supported on short

[Read More](#)

Comoros molded fiberglass cable trays Turkey

All Companies and suppliers for comoros-molded-fiberglass-cable-trays Find wholesalers and contact them directly Leading B2B marketplace Find companies now!

[Read More](#)

Cable Tray System and Joints

Cable Support Systems resist acids, salts, alkalis and a wide range of aggressive chemicals and environments which have drastic effects on galvanized steel and

[Read More](#)



GUIDE CABLE TRAYS TECHNICAL

In accordance with its continuous improvement policy, Legrand reserves the right to change the specifications and illustrations without notice. All illustrations, descriptions and technical information

[Read More](#)

Safe Working Load (SWL)

3. CM150 Wire Cable Tray SWL Considering safety and costs, the wire cable trays are suggested to be supported at a span of 2.0m by trapeze, wall, floor or channel mounting methods. Make the first span

[Read More](#)

Contact Us

For datasheets, pricing, or custom data center infrastructure solutions, please visit:
<https://www.zeldaterblanchephotography.co.za>